

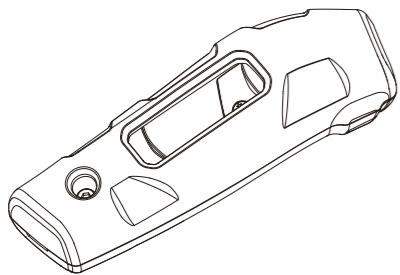

Indicator Extension Instruction Manual



azuto.co.jp/en/

Compatible car models

Jeep Wrangler(JL) : 2017~ (Common to 4 door and 2 door)
SPORT/WILLYS/SAHARA/RUBICON/ALTITUDE/TIDE/392

Jeep WRANGLER (4xe) : 2021~
SAHARA/RUBICON/ALTITUDE

*The product cannot be installed in vehicles with a Sky One-Touch Power Top.

Jeep Gladiator(JT) : 2022~

SPORT/WILLYS/ALTITUDE/RUBICON/OVERLAND/MOJAVE

Thank you for your purchase.

Please read this user's manual in its entirety before using the product.

Specialized skills and knowledge are required to properly install this product. If you are not confident that you can complete installation on your own, we recommend hiring a specialist.
* Note to hired installation specialists
Make sure to return this user's manual to the owner after installation.



548MHG044006A

Installation procedure

1. Attach the rear side of this product to the back of the indicator lever. (Figure 1)

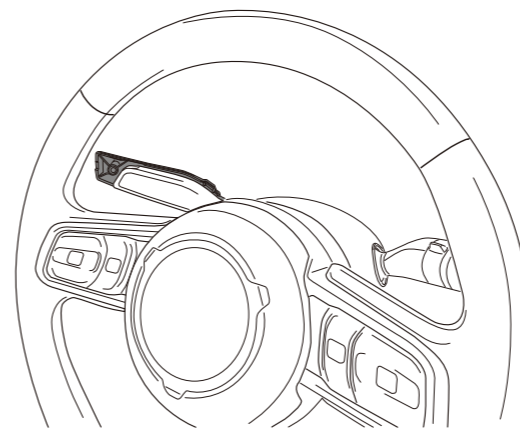

(Figure 1)

2. Insert the extension from the bottom end to match the other end until both ends click into place. (Figure 2)

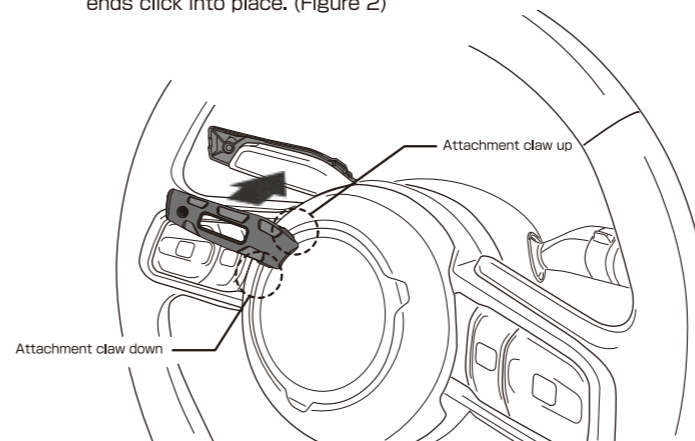

(Figure 2)

3. Using the hex wrench provided, turn the bolt clockwise to fasten the product into place. (Figure 3)

*The bolt is attached to the surface and the product itself.

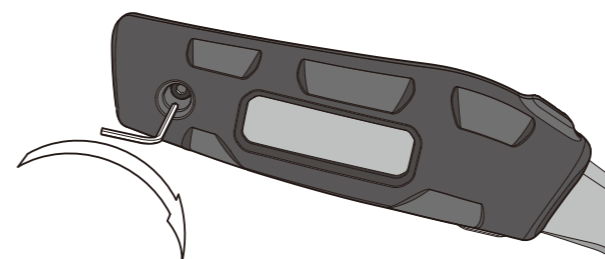

(Figure 3)

4. Check for any rattling. This ends the installation process. (Figure 4)

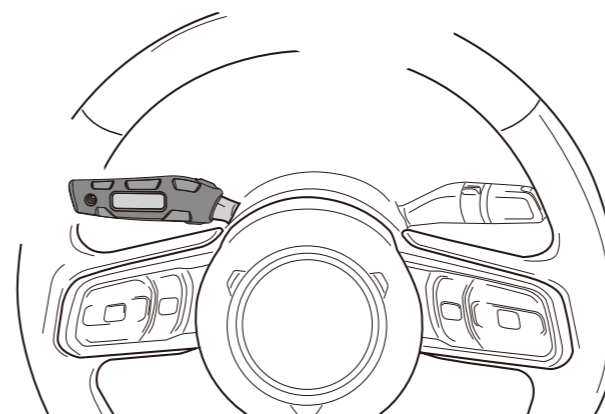

(Figure 4)

Removal

5. Using the hex wrench provided, turn the bolt anti-clockwise to loosen the product. (Figure 5)

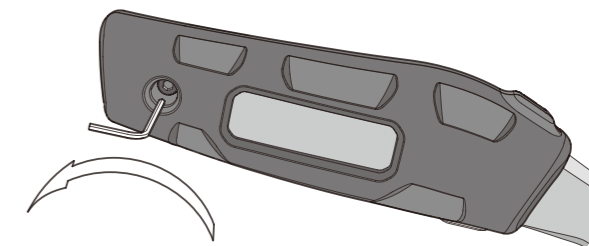

(Figure 5)

6. Insert a flat-head screwdriver or similar implement into the hole shown in (Figure 6) to press the attachment claw down and pry it loose.

*Cover the end of the flat-head screwdriver or other implement with tape to avoid scratching the product or the indicator lever.

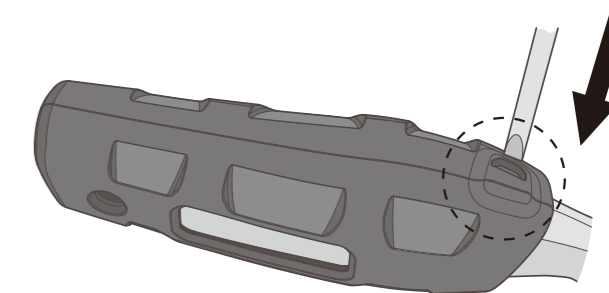

(Figure 6)

7. Holding the side of the product closest to you, gently pull the product towards you to remove it. (Figure 7)

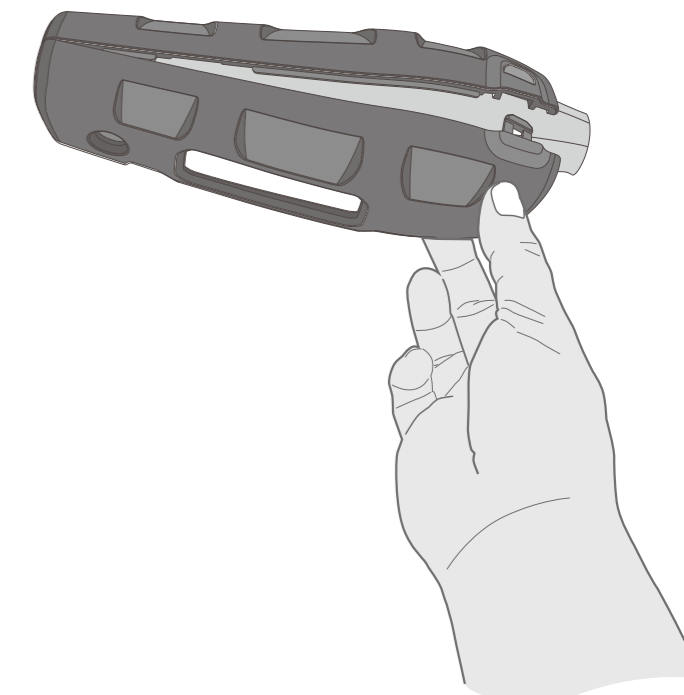

(Figure 7)

Parts

Check that all of the following parts are provided before installing this product.

① indicator extension (main unit)	1 piece
② hex wrench H2.5	1 piece

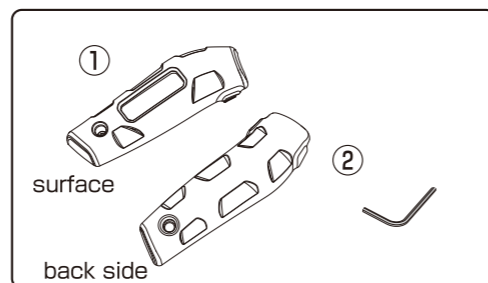

Installation location

Installation location for right-hand drive/left-hand drive vehicles.

(As of Jul. 2023)

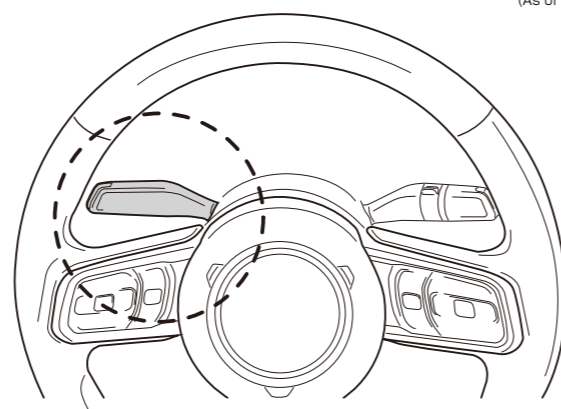

This user's manual contains important warnings and user notices. Please keep it in an easily accessible location inside the vehicle to facilitate reference at any time.

FORTE

- This extends the turn signal lever on the Wrangler, which is further away from the driver than other cars, some 25 mm to improve operability by alleviating any difficulty in gripping the turn signal lever, and reducing the weight resistance in using the turn signal by about 20%.
- It is easy to install simply by fastening the product with the wrench provided.
- The high-grade coating finish matches the color of the car's interior.

WARNING

- To ensure user safety, the driver should refrain from inserting and removing beverage containers when the vehicle is in motion.
- SEIKOSANGYO CO., LTD. is not responsible for any accident, breakdown, malfunction or loss resulting from incorrect installation, disassembly or alteration of the product caused by failure to follow the warnings and user notices in this manual.

User Notice

- This product is an indicator extension for the Wrangler JL/JT. This product cannot be installed in any other locations.
- * This product is compatible with vehicles as of June 2023. This product may not be compatible with vehicles that undergo minor design changes after the verification date.
- This product is highly dangerous if it comes loose after installation. Make sure to retighten the product using the wrench provided on a regular basis (every 300 to 600 mile traveled).
- Although this product uses materials with excellent heat and weather resistance, be aware that the product may change shape due to excessive heat inside the vehicle or deterioration over time.
- We will not be liable or provide compensation for any changes caused by using this product such as failures or damage (breakage, scratches, discoloration, marks, etc.) that may occur to the sides of the vehicle.
- This product may discolor or deteriorate due to the usage environment or aging.
- Never disassemble or modify this product.

Contact Information for Product-related Inquiries

Customer Service Center E-mail : azuto-mk@seikosangyo.co.jp 561-1, Komatsugawa, Yoshikawa-shi, Saitama, 342-0043, Japan
azuto.co.jp/en/

SEIKOSANGYO CO., LTD.

* Jeep is a registered trademark of Stellantis N.V.
* AZUTO is a registered trademark of SEIKOSANGYO CO., LTD.
* Planning, design and quality control for this product were carried out in Japan.
* Product specifications and appearance are subject to change without prior notice.
* All other product names, etc. used in this document are the trademark or registered trademark of their respective owners.

Main material PC

CA Made in CHINA