

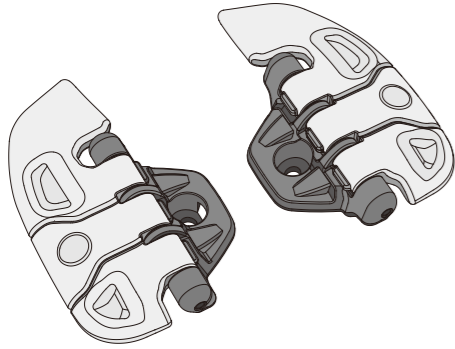

Paddle Switches Instruction Manual



Compatible car models

Jeep Wrangler(JL) : 2017~ (Common to 4 door and 2 door)
SPORT/WILLYS/SAHARA/RUBICON/ALTITUDE/TIDE
Jeep WRANGLER (4xe) : 2021~
SAHARA/RUBICON/ALTITUDE
*The product cannot be installed in 392Model.
Jeep Gladiator(JT) : 2022~
SPORT/WILLYS/ALTITUDE/RUBICON/OVERLAND/MOJAVE

Thank you for your purchase.
Please read this user's manual in its entirety before using the product.

Specialized skills and knowledge are required to properly install this product.
If you are not confident that you can complete installation on your own, we recommend hiring a specialist.
* Note to hired installation specialists
Make sure to return this user's manual to the owner after installation.



548MHG048006A

Installation procedure

1.Remove the caps from the left and right sides behind the steering wheel.
Please keep the removed caps in a safe place.
(Figure 1)

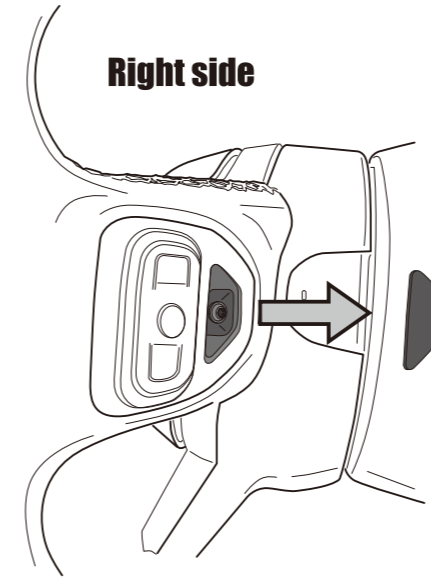

(Figure 1)

3.Use the included Hexalobe screws to securely fasten the product to the steering wheel on both sides. (Figure 3)

⚠ If the paddle is reluctant to move after installation, loosen the screws a little.
*Please ensure to use the included Hexalobe screws.

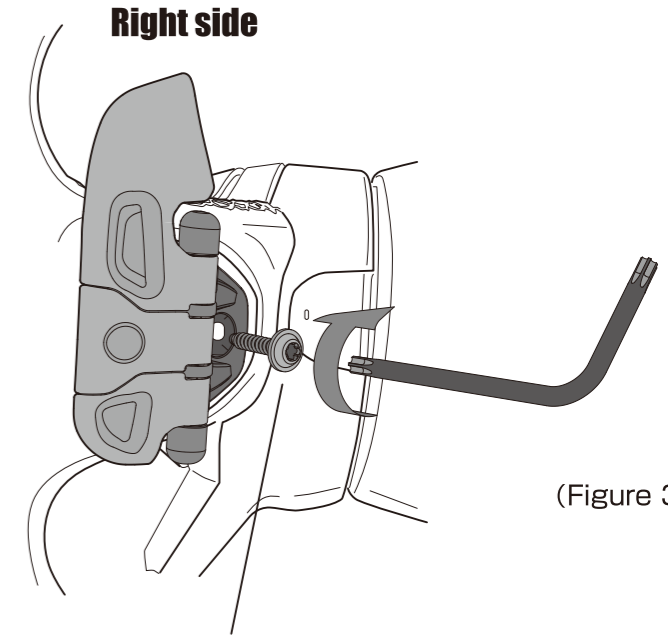

(Figure 3)

Please ensure to use the included Hexalobe screws.

2.Remove the screws on both sides using the included Hexalobe wrench. Please keep the removed screws in a safe place.(Figure 2)

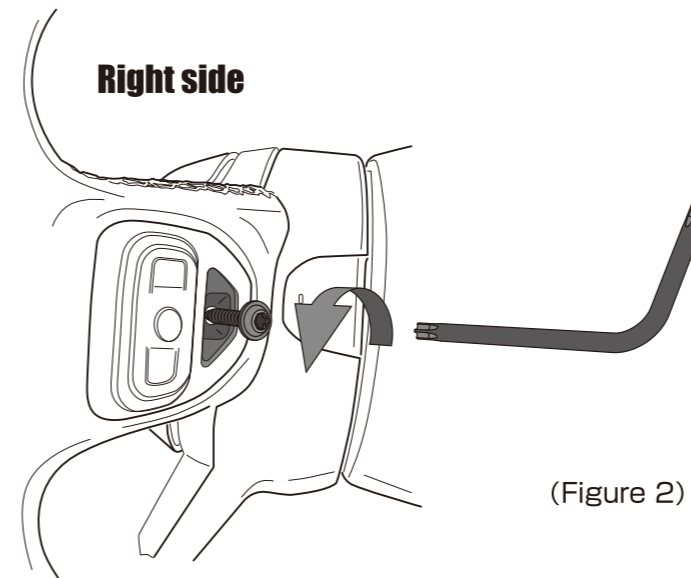

(Figure 2)

4.Ensure that there is no rattling in the product before completing the process.(Figure 4)

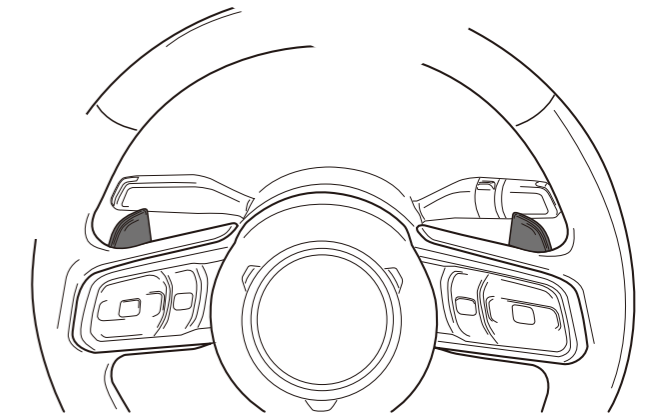

(Figure 4)

Removal

5.To remove, follow steps 1 to 3 in reverse order.

*Please keep the removed caps and screws in a safe place. These are required for restoration to the original condition.

Parts

Check that all of the following parts are provided before installing this product.

(1) Paddle switche Right side	1 piece
(2) Paddle switche Left side	1 piece
(3) Hexalobe wrench	1 piece
(4) Hexalobe screw	2 pieces

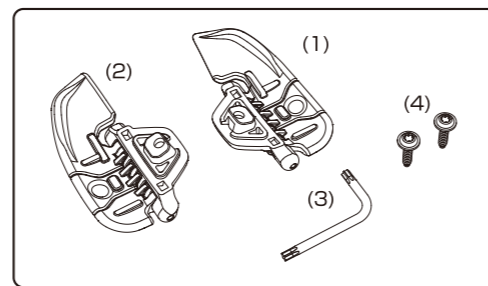

Installation location

Installation location for right-hand drive/left-hand drive vehicles.

(As of Jul. 2024)

Back Side

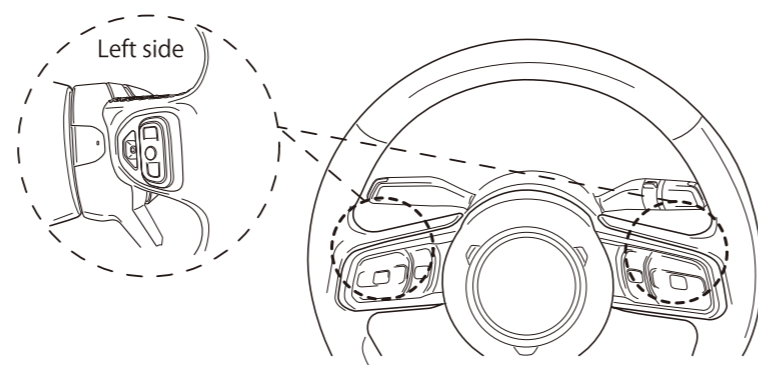

This user's manual contains important warnings and user notices. Please keep it in an easily accessible location inside the vehicle to facilitate reference at any time.

FORTE

- Introducing the paddle switch designed to enhance the operability of the steering wheel switch, inspired by the paddle shift, available exclusively on the top-tier Wrangler JL model, 392.
- Installation is simple-just tighten the included screws with the included wrench.
- The chrome finish around the steering complements the interior seamlessly.

⚠ WARNING

- To ensure user safety, the driver should refrain from inserting and removing beverage containers when the vehicle is in motion.
- SEIKOSANGYO CO., LTD. is not responsible for any accident, breakdown, malfunction or loss resulting from incorrect installation, disassembly or alteration of the product caused by failure to follow the warnings and user notices in this manual.

⚠ User Notice

- This product is a steering wheel paddle switches for the Jeep Wrangler JL/JT, cannot be installed in any other locations.
- This product does not allow for shift operations.
- *This product is compatible with vehicles as of April 2024. This product may not be compatible with vehicles that have undergone a minor change after the date of the survey.
- *This product cannot be installed on vehicles equipped with a Wrangler 392 model or 392 model steering wheel.
- After installing, it is extremely dangerous if it loosens, so please use the included wrench to periodically retighten it every 500 to 1000 kilometers.
- This product is made of heat-resistant and weatherable materials; however, it may deform due to excessive heat inside the car or aging over time.
- When using this product, our company cannot assume responsibility or provide compensation for any damages (such as breakage, scratches, discoloration, or marks) that occur to the vehicle as compared to before use.
- Never attempt to disassemble or modify this product.

Contact Information for Product-related Inquiries

Customer Service Center E-mail : azuto-mk@seikosangyo.co.jp
azuto.co.jp/en/

561-1, Komatsugawa, Yoshikawa-shi,
Saitama, 342-0043, Japan
SEIKOSANGYO CO., LTD.

* Jeep is a registered trademark of Stellantis N.V.
* AZUTO is a registered trademark of SEIKOSANGYO CO., LTD.
* Planning,design and quality control for this product were carried out in Japan.
* Product specifications and appearance are subject to change without prior notice.
* All other product names, etc. used in this document are the trademark or registered trademark of their respective owners.

Main material ABS

CA- Made in CHINA